

## GRAVINOX 300 & GRAVINOX 350

*These slicers are unique in the market. They are strong and accurate, facilitating a perfect cut through its reliable operation.*

*Its entirely stainless steel and open design ensures ease of cleaning and complete hygiene.*

- 304 Stainless Steel
- Very robust
- Belt driven
- Corrosion resistant
- Thickness adjustable 0 - 25 mm (0 - 1 inch)
- Automatically operated independent sharpener
- Very flexible sliding and removable carriage (included)
- Easy access for cleaning
- IP63 waterproof
- Complies with CE standards
- UL, NSF, CSA certification



GRAVINOX 300 & GRAVINOX 350

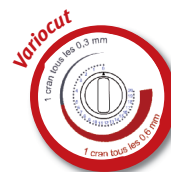

Stainless Steel adjusting button with Variocut system

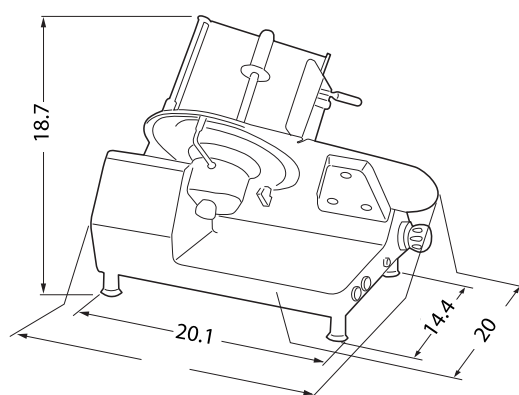

Dimensions GRAVINOX 300

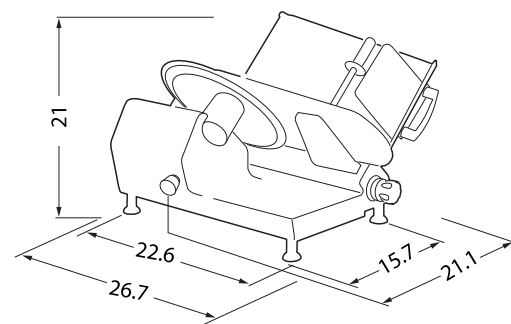

Dimensions GRAVINOX 350

	Type	Cut capacity (in)	Tension	Blade diameter (in)	Motor	Weight (Lbs)
GRAVINOX 300	Manual - Gravity	10 x 6.3 or Ø 8.2	110V 60Hz	12	0.27HP	95
GRAVINOX 350	Manual - Gravity	11 x 7 or Ø 9.5	110V 60Hz	14	0.37HP	108